

SHIELD COOL & HOT WATER CIRCULATION BOOSTER PUMP

USER INSTRUCTION



Please read this guide carefully , before you use this type pumps

INSTALLATION DIMENSION

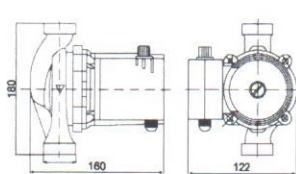

20PBG-6/7/8-N (B)
25PBG-6/7/8-N (B)

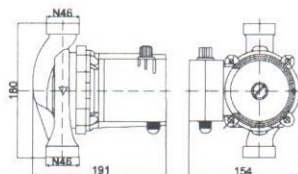

25PBG-9-N
25PBG-10-N

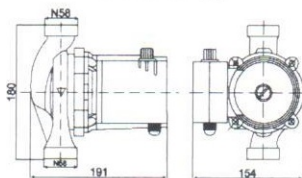

32PBG-9-N
32PBG-10-N

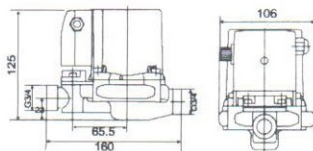

15PBG-7-N (E, F, G)
15PBG-8-N (B, F, G)

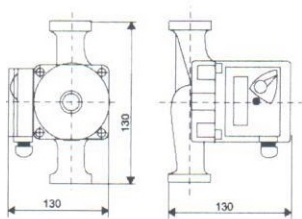

20PBG-6-N (C)
25PBG-6-N (C)

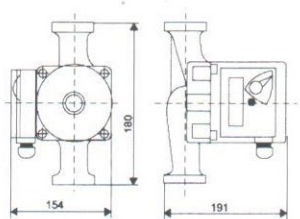

25PBG-8-N (D)
32PBG-8-N (D)

INSTALLATION DIMENSION

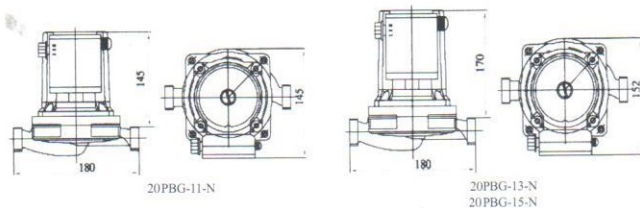
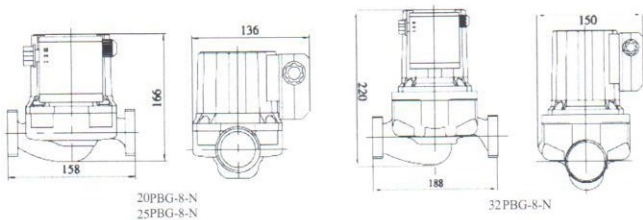
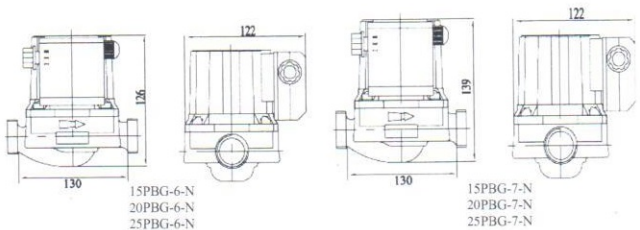



SPECIAL PUMP USED FOR GAS HANGING BOILER



15PBG-6-N (Z) 15PBG-7-N (Z)
20PBG-6-N (Z) 20PBG-7-N (Z)
25PBG-6-N (Z) 25PBG-7-N (Z)



15PBG-6-N (ZA) 15PBG-7-N (ZA)
20PBG-6-N (ZA) 20PBG-7-N (ZA)
25PBG-6-N (ZA) 25PBG-7-N (ZA)



15PBG-6-N (ZB) 15PBG-7-N (ZB)
20PBG-6-N (ZB) 20PBG-7-N (ZB)
25PBG-6-N (ZB) 25PBG-7-N (ZB)

Features

This pump equips with temperature autocontrol set based on primary circulation pump, which realize auto power-on and shut-down function through water temperature. It adopts LCD screen and incorporate design of temperature controller and circulation pump, which is convenient to manipulate and install.

Installation Dimensions

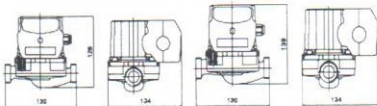

15PBG-6-N(Z)
20PBG-6-N(Z)
25PBG-6-N(Z)

15PBG-7-N(Z)
20PBG-7-N(Z)
25PBG-7-N(Z)

Structure Chart

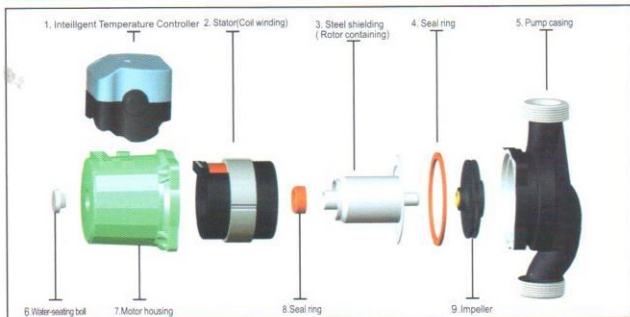



TECHNICAL DATA & PERFORMANCE CURVE

Model 20PBG-9-N 25PBC-9-N					
Max. Power	235W	Dia	32mm($\frac{1}{4}$ " ¹)	G.W.	26 kg
Rated Power	180W	Voltage	220V	Qty	4 Pcs
Min. Power	120W	Frequency	50Hz	Package Dimension	38.8x33.8x21.8cm

Position	Highest Head (m)	Max.Capacity (L/min)	Speed (r/min)
III	9	135	2680
II	8	95	2220
I	6	75	1680

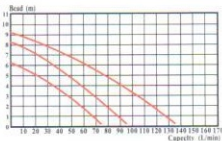

Model 32PBG-9-N					
Max. Power	235W	Dia	32mm($\frac{1}{4}$ " ¹)	G.W.	29 kg
Rated Power	180W	Voltage	220V	Qty	4 Pcs
Min. Power	120W	Frequency	50Hz	Package Dimension	38.8x33.8x21.8cm

Position	Highest Head (m)	Max.Capacity (L/min)	Speed (r/min)
III	9	150	2680
II	8	105	2220
I	6	85	1680

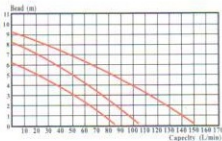

Model 20PBG-10-N 25PBC-10-N					
Max. Power	320W	Dia	32mm($\frac{1}{4}$ " ¹)	G.W.	26 kg
Rated Power	250W	Voltage	220V	Qty	4 Pcs
Min. Power	205W	Frequency	50Hz	Package Dimension	38.8x33.8x21.8cm

Position	Highest Head (m)	Max.Capacity (L/min)	Speed (r/min)
III	10	145	2800
II	8	105	2320
I	6	80	1780

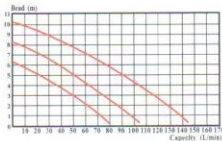

Model 32PBG-10-N					
Max. Power	320W	Dia	32mm($\frac{1}{4}$ " ¹)	G.W.	29kg
Rated Power	250W	Voltage	220V	Qty	4 Pcs
Min. Power	205W	Frequency	50Hz	Package Dimension	38.8x33.8x21.8cm

Position	Highest Head (m)	Max.Capacity (L/min)	Speed (r/min)
III	10	165	2800
II	8	120	2300
I	6	95	1780

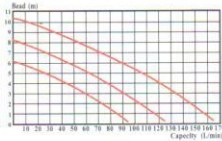

Model	Max.Power (W)	Voltage (V)	Frequency (Hz)	Input&Outlet Dia (mm)(in)	Speed (r/min)	Highest Head (m)	Max.Capacity (L/min)	G.W. (Kg)			Q'ty (Pcs)	Package Dimension (cm)
								E	G	H		
15PBG-9-N	120	220	50	15mm($\frac{1}{2}$ " ¹)	2800	9	40	26	21	8	34.8x25.5x32.5	
15PBG-10-N	150	220	50	15mm($\frac{1}{2}$ " ¹)	2800	10	45	26.5	21.5	8	34.8x25.5x32.5	

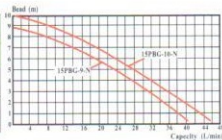

TECHNICAL DATA & PERFORMANCE CURVE

Model 20PBG-12-N(D)					
Max. Power	265W	Dia	20mm($\frac{3}{4}$ "	G.W.	19.8kg
Rated Power	225W	Voltage	220V	Q'ty	4 Pcs
Min. Power	180W	Frequency	50Hz	Package Dimension	38.8x32.5x18.5cm

Position	Highest Head (m)	Max.Capacity (L/min)	Speed (r/min)
III	12	50	2520
II	9	40	2100
I	6	30	1700

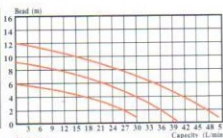

Model 25PBG-8-N(D)					
Max. Power	225W	Dia	25mm(1"	G.W.	25.5 kg
Rated Power	180W	Voltage	220V	Q'ty	4 Pcs
Min. Power	135W	Frequency	50Hz	Package Dimension	38.8x33.5x21cm

Position	Highest Head (m)	Max.Capacity (L/min)	Speed (r/min)
III	8	210	2520
II	7	150	2100
I	5	100	1700

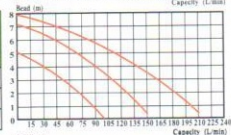

Model 32PBG-8-N(D)					
Max. Power	225W	Dia	32mm($1\frac{1}{4}$ "	G.W.	28kg
Rated Power	180W	Voltage	220V	Q'ty	4 Pcs
Min. Power	135W	Frequency	50Hz	Package Dimension	38.8x33.5x21cm

Position	Highest Head (m)	Max.Capacity (L/min)	Speed (r/min)
III	8	230	2520
II	7	170	2100
I	5	120	1700

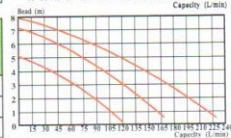

Model 20PBG-11-N					
Max. Power	150W	Dia	20mm($\frac{3}{4}$ "	G.W.	19kg
Rated Power	120W	Voltage	220V	Q'ty	4 Pcs
Min. Power	80W	Frequency	50Hz	Package Dimension	38.8x30.8x17.5cm

Position	Highest Head (m)	Max.Capacity (L/min)	Speed (r/min)
III	11	35	2410
II	8	25	2080
I	5	18	1680

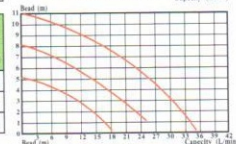

Model 20PBG-13-N					
Max. Power	280W	Dia	20mm($\frac{3}{4}$ "	G.W.	25kg
Rated Power	250W	Voltage	220-240V	Q'ty	4 Pcs
Min. Power	120W	Frequency	50Hz	Package Dimension	38.8x33.2x20.3cm

Position	Highest Head (m)	Max.Capacity (L/min)	Speed (r/min)
III	13	65	2450
II	10	55	2150
I	6	30	1800

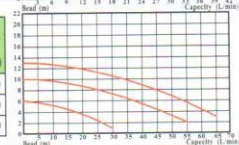

Model 20PBG-15-N					
Max. Power	320W	Dia	20mm($\frac{3}{4}$ "	G.W.	25kg
Rated Power	250W	Voltage	220-240V	Q'ty	4 Pcs
Min. Power	150W	Frequency	50Hz	Package Dimension	38.8x33.2x20.3cm

Position	Highest Head (m)	Max.Capacity (L/min)	Speed (r/min)
III	15	75	2450
II	11	65	2150
I	7	40	1800

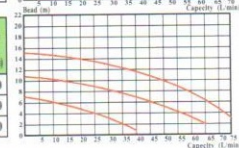



TECHNICAL DATA

Model 20PBG-12-N(D)					
Max. Power	120W	Dia	20mm($\frac{3}{4}$ "	G.W.	25kg
Rated Power	90W	Voltage	220V	Qty	8 Pcs
Min. Power	60W	Frequency	50Hz	Package Dimension	38.8x28x33.6cm

Position	Highest Head (m)	Max.Capacity (L/min)	Speed (r/min)
III	6	70	2410
II	4	45	2080
I	3	30	1680



Model 25PBG-6-N(B)					
Max. Power	120W	Dia	25mm(1")	G.W.	26 kg
Rated Power	90W	Voltage	220V	Qty	8 Pcs
Min. Power	60W	Frequency	50Hz	Package Dimension	38.8x28x33.6cm

Position	Highest Head (m)	Max.Capacity (L/min)	Speed (r/min)
III	6	80	2410
II	4	55	2080
I	3	35	1680

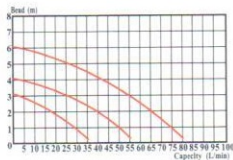

Model 20PBG-7-N(B)					
Max. Power	150W	Dia	20mm($\frac{3}{4}$ "	G.W.	25 kg
Rated Power	120W	Voltage	220-240V	Qty	8 Pcs
Min. Power	90W	Frequency	50Hz	Package Dimension	38.8x28x35.6cm

Position	Highest Head (m)	Max.Capacity (L/min)	Speed (r/min)
III	7	75	2520
II	5	50	2180
I	4	35	1700

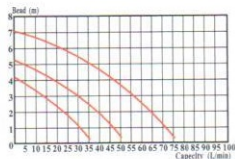

Model 25PBG-7-N(B)					
Max. Power	150W	Dia	25mm(1")	G.W.	26 kg
Rated Power	120W	Voltage	220-240V	Qty	8 Pcs
Min. Power	90W	Frequency	50Hz	Package Dimension	38.8x28x35.6cm

Position	Highest Head (m)	Max.Capacity (L/min)	Speed (r/min)
III	7	90	2520
II	5	60	2180
I	4	40	1700

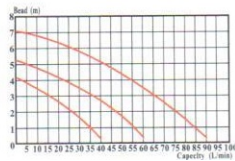



TECHNICAL DATA & PERFORMANCE CURVE

Model 15PBG-6-N					
Max. Power	100W	Dia	15mm($\frac{1}{2}$ "	G.W.	22.5 kg
Rated Power	90W	Voltage	220V	Qty	8 Pcs
Min. Power	46W	Frequency	50Hz	Package Dimension	28.8x28x29.6cm

Position	Highest Head (m)	Max.Capacity (L/min)	Speed (r/min)
III	6	40	2200
II	5	35	1900
I	3	20	1450

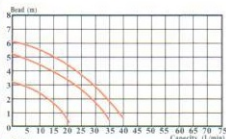

Model 20PBG-6-N					
Max. Power	100W	Dia	20mm($\frac{3}{4}$ "	G.W.	23.2 kg
Rated Power	90W	Voltage	220V	Qty	8 Pcs
Min. Power	46W	Frequency	50Hz	Package Dimension	28.8x28x29.6cm

Position	Highest Head (m)	Max.Capacity (L/min)	Speed (r/min)
III	6	50	2200
II	5	40	1900
I	3	25	1450

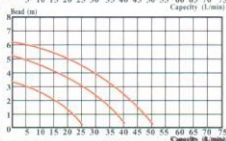

Model 25PBG-6-N					
Max. Power	100W	Dia	25mm(1"	G.W.	26.2 kg
Rated Power	90W	Voltage	220V	Qty	8 Pcs
Min. Power	46W	Frequency	50Hz	Package Dimension	28.8x28x29.6cm

Position	Highest Head (m)	Max.Capacity (L/min)	Speed (r/min)
III	6	60	2200
II	5	50	1900
I	3	30	1450

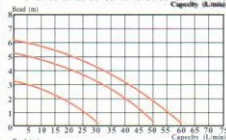

Model 15PBG-7-N					
Max. Power	130W	Dia	15mm($\frac{1}{2}$ "	G.W.	25.5 kg
Rated Power	120W	Voltage	220V	Qty	8 Pcs
Min. Power	60W	Frequency	50Hz	Package Dimension	28.8x28x31.6cm

Position	Highest Head (m)	Max.Capacity (L/min)	Speed (r/min)
III	7	50	2520
II	6	40	2220
I	4	25	1680

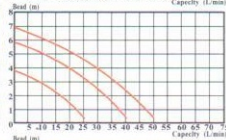

Model 20PBG-7-N					
Max. Power	130W	Dia	20mm($\frac{3}{4}$ "	G.W.	26.3 kg
Rated Power	120W	Voltage	220V	Qty	8 Pcs
Min. Power	60W	Frequency	50Hz	Package Dimension	28.8x28x31.6cm

Position	Highest Head (m)	Max.Capacity (L/min)	Speed (r/min)
III	7	60	2520
II	6	50	2220
I	4	30	1680

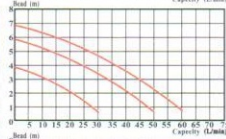

Model 25PBG-7-N					
Max. Power	130W	Dia	25mm(1"	G.W.	29.3 kg
Rated Power	120W	Voltage	220V	Qty	8 Pcs
Min. Power	60W	Frequency	50Hz	Package Dimension	28.8x28x31.6cm

Position	Highest Head (m)	Max.Capacity (L/min)	Speed (r/min)
III	7	75	2520
II	6	60	2220
I	4	35	1680

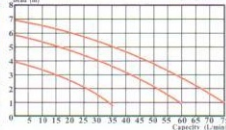

MODEL EXPLAIN

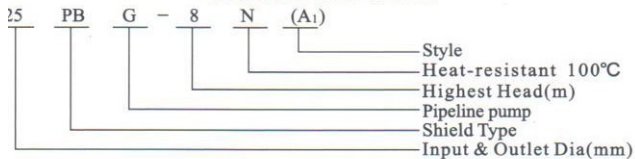

THREE-DIMENSIONAL STRUCTURE

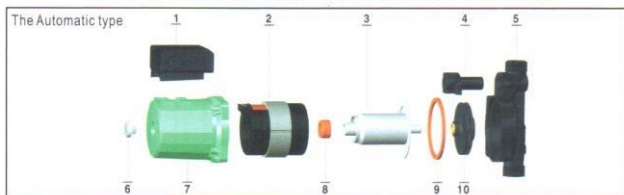

N.	Description	N.	Description
1	Terminal box	6	Water-sealing bolt
2	Stator(Coil winding)	7	Motor housing
3	Steel shielding (Rotor containing)	8	Seal ring
4	Automatic switch	9	Seal ring
5	Pump casing	10	Impeller

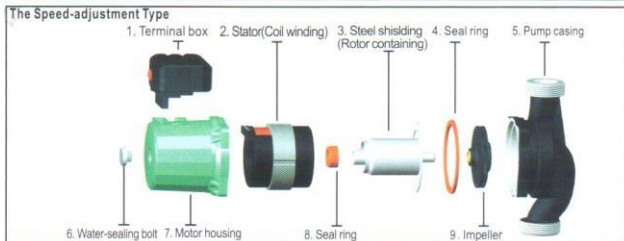

USE OCCASION

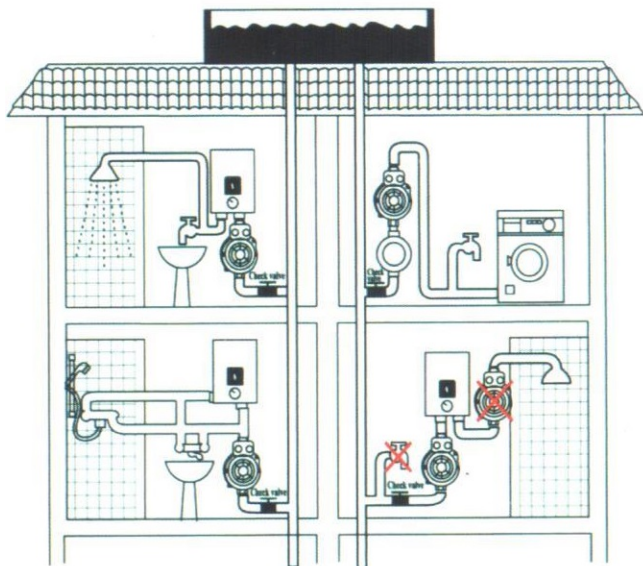

- Please don't install the pumps at the outlet of the water heater
- Please don't install the taps at the inlet of the water pumps

PUMP EXHAUST

Although the pump and water heater are working, but no central heating because there's air in the pipe line to lead no circulation. Under general circumstance , after sometime working, we should use manual way.

- ① Before using, please exhaust first.
- ② If the pump continue working one week for hot water circulation, please exhaust one time per week.

Exhaustion methods:

At first cut off the power and close the outer tap, then slowly twist the exhausting screw, use screw drive turn the pump shaft 15-30 seconds later, there will be some liquid coming out. After exhaustion , please tighten the screw on time.

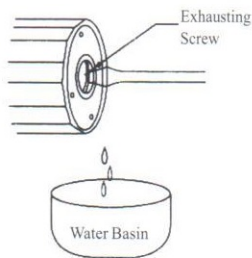

Note: To avoid be scalded by the steam or hot-warer during exhausting, plcasd don't face the vent directly.

INSTALLATION SKETCH MAP

Pump must be installed horizontal, don't install inversion or vertical

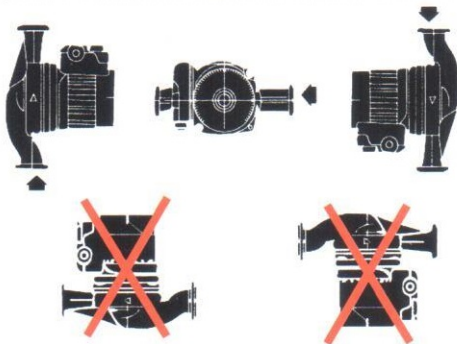

The wiring must be installed radian when connect to the junction box. To avoid the water going inside of the box.

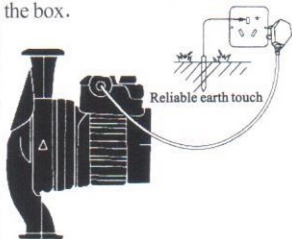

Please use tools to connect with pipeline, when fix the outlet& inlet of the pumps, don't use hands directly to return at the motor, avoiding screw loose or inside locked.



PRECAUTION

1. When connect to the power supply, let the pump work several seconds to inspect the start-up normal or not. But don't let the pump working no water long time to affect the ceramic bearing span. Special the self-auto water pump, in case of no water suddenly, u should pay more attention to aviod unnecessary loss.
2. Pls pay attention to the water drop on the wood floor or easily moisture goods, when exhausting the air or maintenance.
3. Don't touch to avoid scald when our pump using in the heating system. The wiring materials must be heating-reslstant.
4. Before installation, make sure the pipeline welding well and clean. If there have foreign substance, welding clinker, dirt, they will damage the water pump.
5. The place, where to install the pump, should be convenient to maintenance and change.
6. We suggest that pls separate install the check valve at inlet or outlet for the maintenance. Then it can avoid the leaking water drop to the water pump and the junction box.
7. Current flow direction should be same as the arrow on the pump.
8. When the diirection of the junction box isn't right, u can loose the hexangular screw, return the motor to the right position. Pls don't damage the rubber gasker, then re-tighten the screw and check the seal gasket is ok or not.

WORKING CONDATION

1. Medium transportation temperature: 0°C ~+ 110°C
2. Max circumstance temperature: + 40°C
3. Medium condition: clean, no solid substance, no mineral & oil substance, no stickiness.
4. Chem. condition: near neutral, non-cauterization, non-explosion similar water (glycol max content: 30%)
5. If you want to use other kinds liquids, please consult the factory.
6. Max working pressure: 10bar
7. Min. inlet pressure:

a. At+50°C	0,05bar
b. At+95°C	0,3bar
c. At+110°C	1,0bar

All above, they are only suitable for altitude 300m, much higher 100m by 0.01bar adding. To avoid air-causticity, which making noise, you should keep min. pressure limitation.

The pump must be working at rated voltage range $\pm 10\%$, if the voltage is too lower, the pump will be coming out low speed or hardly start up, easily heating, lower head and pressure.

PRODUCTS SHOW



20PBG-6-N (B)
20PBG-7-N (B)



20PBG-6-N (B-A)
20PBG-7-N (B-A)



25PBG-6-N
25PBG-7-N



25PBG-6-N (B-A)
25PBG-7-N (B-A)



20PBG-6-N (C)
25PBG-6-N (C)



25PBG-6-N (D)
32PBG-6-N (D)



20PBG-12-N (D)



25PBG-8-N (D)
32PBG-8-N (D)



20PBG-9-N
20PBG-10-N



25PBG-9-N 32PBG-9-N
25PBG-10-N 32PBG-10-N



20PBG-11-N
20PBG-13-N
20PBG-15-N



20PBG-11-N (A)
20PBG-13-N (A)
20PBG-15-N (A)

Dear our customer:

Thank you for your purchase this series water pump and hereby we celebrate your water using problem can be completely solved. When u first use this kind pump, please read this instruction carefully and well keep it. As the instruction guide, u will use them correctly and elaborate all the best features and efficiency, no fault, to increase the using span. Our company's products will be continuous develop and create, if your purchase pump is not same as the instruction's structure, performance and specification, please following the pump Nameplate.



SPECIAL WARNING

Before using, the pump must be reliable earth touch. Don't change the three-core wiring plug to avoid the power leakage. To make sure everything safe, please u must install some security measures, such as: the power leakage-broker or electric shock blocker and so on.

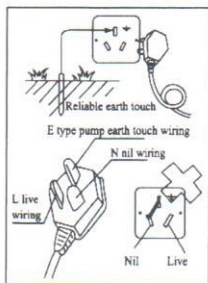

1. Earth wiring and nil wiring must be separated. If no reliable earth wiring, the accident will be no business with us.

This type water pump's plug feet, if "L" is Live Wiring, "N" is Nil Wiring, the longest one is "E" earth touch wiring. Customer must pay attention to the connection to the piugh, when you install the three-core socket.

Here we absolutely forbid u: unite the Nil wiring and Earth Wiring together, which can make power leakage dangerous.

2. Don't use blanket cover the motor or the pumps, Keep ventilation to avoid fire dangerous.
3. If you install our pump outdoor, please u should do some protection measures. Or it will decrease the using life span because of the sun-baked and raining. Worst it can make electric shock accident. If you install our pump indoor, please avoid water spill to make electric shock; don't install inside the bathroom to avoid the cream and water going inside.
4. After a few years of normal use, if you hear any sound in the motor, please replace the internal shield components timely to prevent the danger of electric shock hazard by water leakage.

Warning

- The appliance is not to be used by persons (including children) with reduced physical, sensory or mental capabilities, or lack of experience and knowledge, unless they have been given supervision or instruction.
- Children should be supervised not to play with the appliance.
- If the supply cord is damaged it must be replaced by the manufacturer or its service agent in order to avoid a hazard.